

Anti-Loss Washers

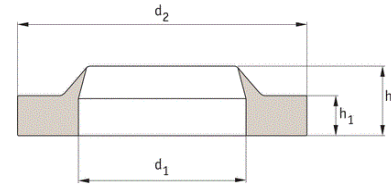

Anti-Loss Washers									
For Thread	M3.5	M4	M5	M6	M8	M10	1/4	3/8	1/2
d1	3.6	4.1	5.0	6.3	8.2	10.5	13.2	17.7	21.5
d2	9.1	9.0	10.1	12.5	16.2	15.0	18.9	23.0	27.6
h1	1.2	1.6	1.6	1.3	1.6	2.1	2.6	2.1	2.1
h2	2.7	3.0	3.1	2.7	3.5	4.3	4.5	4.5	4.2

Material: Nylon 66 Natural

Application

Anti-loss Washer's Tapered Design Results In Tapered Part Clinching Into The Pitch Of The Thread, Preventing Loss.
Can Only Be Removed By Fully Unscrewing The Washer

INFORMATION AND DRAWINGS PROVIDED ARE FOR REFERENCE ONLY